

REVISIONS			
REV.	DESCRIPTION	DATE	APPROVED
B	Redrawn in Solidworks	12/23/2022	RAS

$\phi .385\text{in} [9.78\text{mm}]$
 $\phi .650\text{in} [16.51\text{mm}]$

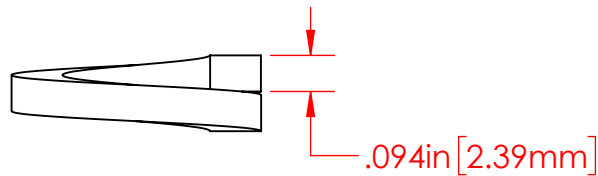
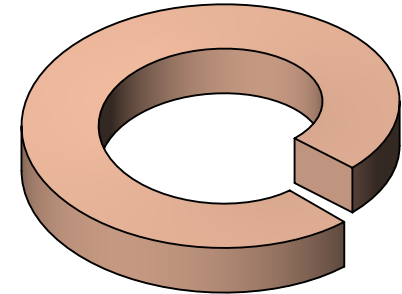
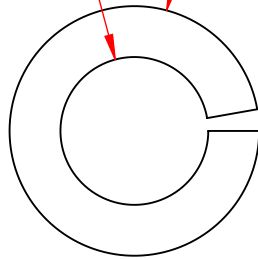

P/N 3641-000
 Bronze Alloy
 Lock Washer

Part Material :
 Bronze Alloy

ALL DIMENSIONS GIVEN AS : INCH [METRIC]
 TOLERANCES UNLESS OTHERWISE SPECIFIED :
 HARDWARE PRODUCTS : $\pm .010"$ / $\pm 0.25\text{mm}$

PRINTED COPIES ARE NOT CONTROLLED
PROPRIETARY AND CONFIDENTIAL
 THE INFORMATION CONTAINED IN THIS
 DRAWING IS THE SOLE PROPERTY OF
 VTE INCORPORATED. ANY REPRODUCTION
 IN PART OR AS A WHOLE WITHOUT THE WRITTEN
 PERMISSION OF VTE INCORPORATED PROHIBITED.



VTE INCORPORATED

5437 Robinson Road, P.O. Box 790
 Pellston, Michigan 49769 USA
 Telephone : 1-800-527-9256, 231-539-8000
 Fax : 231-539-0914, EFax : 231-344-5914

REV	B	NAME	DATE
DRAWN BY:	RAS	12-23-22	
CHECKED BY:			
SIZE	A	DO NOT SCALE DRAWING	

TITLE: 3/8" Bronze Lock Washer

DWG. NO. **3641-000**