

REVISIONS			
REV.	DESCRIPTION	DATE	APPROVED
C	Redrawn in Solidworks	12-23-2022	RAS

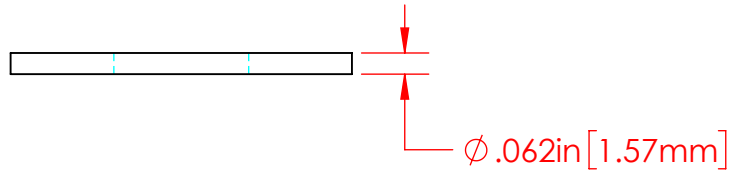

$\phi .395\text{in} \pm .005 [10.03\text{mm} \pm 0.13]$ $\phi 1.000\text{in} [25.40\text{mm}]$

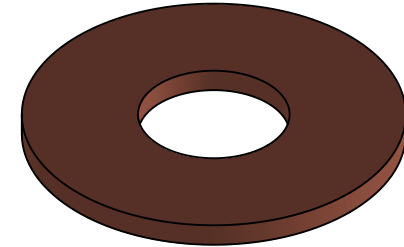
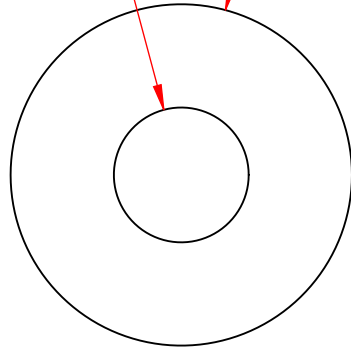

P/N 3648-003
110 Copper Alloy
Flat Washer

Part Material :
110 Copper Alloy

ALL DIMENSIONS GIVEN AS : INCH [METRIC]
TOLERANCES UNLESS OTHERWISE SPECIFIED :
HARDWARE PRODUCTS : $\pm .010"$ / $\pm 0.25\text{mm}$

PRINTED COPIES ARE NOT CONTROLLED
PROPRIETARY AND CONFIDENTIAL
THE INFORMATION CONTAINED IN THIS
DRAWING IS THE SOLE PROPERTY OF
VTE INCORPORATED. ANY REPRODUCTION
IN PART OR AS A WHOLE WITHOUT THE WRITTEN
PERMISSION OF VTE INCORPORATED PROHIBITED.



VTE INCORPORATED

5437 Robinson Road, P.O. Box 790
Pellston, Michigan 49769 USA
Telephone : 1-800-527-9256, 231-539-8000
Fax : 231-539-0914, EFax : 231-344-5914

REV	C	NAME	DATE
DRAWN BY:	RAS	12-23-22	
CHECKED BY:			
SIZE	A	DO NOT SCALE DRAWING	

TITLE: M10 Stainless Steel Flat Washer

DWG. NO. **3648-003**