

REVISIONS			
REV.	DESCRIPTION	DATE	APPROVED
A	Redrawn in Solidworks	12-23-2022	RAS

$\phi 1.000\text{in} [25.40\text{mm}]$   $\phi .500\text{in} \pm .005 [12.70\text{mm} \pm 0.13]$

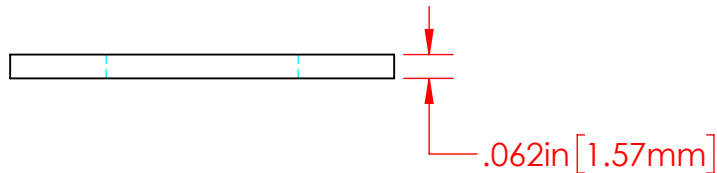
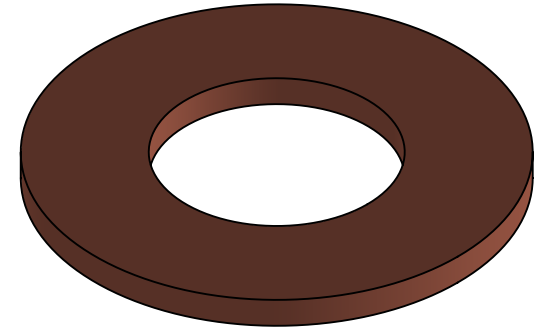
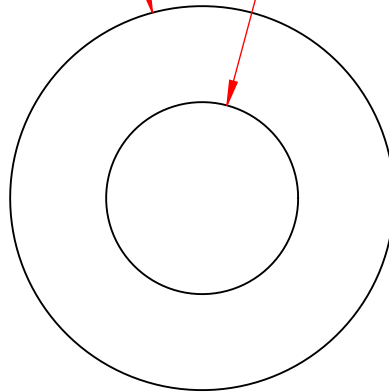

P/N 3648-010  
110 Copper Alloy  
1/2" Flat Washer

Part Material :  
110 Copper Alloy

ALL DIMENSIONS GIVEN AS : INCH [METRIC]  
TOLERANCES UNLESS OTHERWISE SPECIFIED :  
HARDWARE PRODUCTS :  $\pm .010"$  /  $\pm 0.25\text{mm}$

PRINTED COPIES ARE NOT CONTROLLED  
**PROPRIETARY AND CONFIDENTIAL**  
THE INFORMATION CONTAINED IN THIS  
DRAWING IS THE SOLE PROPERTY OF  
VTE INCORPORATED. ANY REPRODUCTION  
IN PART OR AS A WHOLE WITHOUT THE WRITTEN  
PERMISSION OF VTE INCORPORATED PROHIBITED.



**VTE INCORPORATED**

5437 Robinson Road, P.O. Box 790  
Pellston, Michigan 49769 USA  
Telephone : 1-800-527-9256, 231-539-8000  
Fax : 231-539-0914, EFax : 231-344-5914

REV	<b>A</b>	NAME	DATE
SIZE	<b>A</b>	DRAWN BY:	RAS
		CHECKED BY:	12-23-22
		DO NOT SCALE DRAWING	

TITLE: 1/2" Copper Flat Washer

DWG. NO. **3648-010**