

REVISIONS			
REV.	DESCRIPTION	DATE	APPROVED
C	Redrawn in Solidworks	1/12/2023	RAS

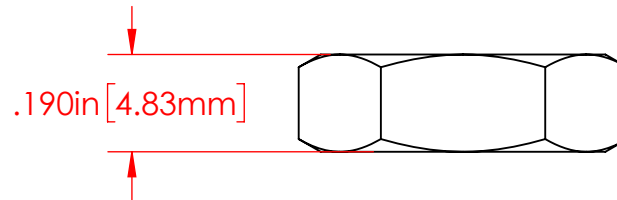
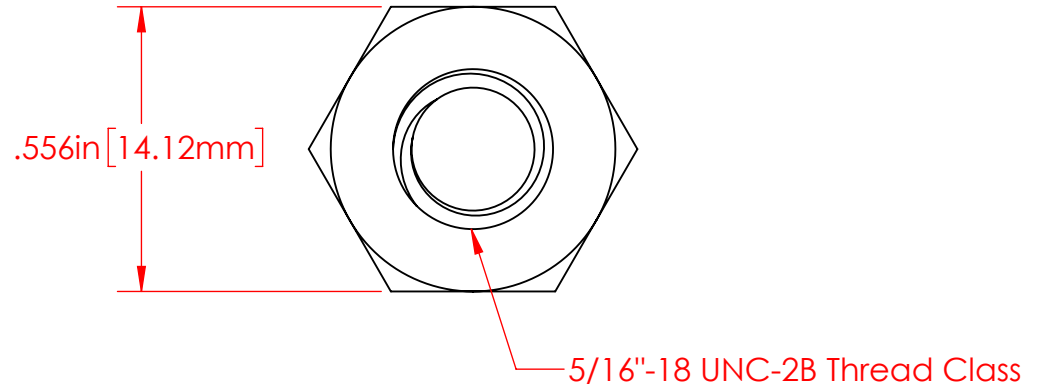
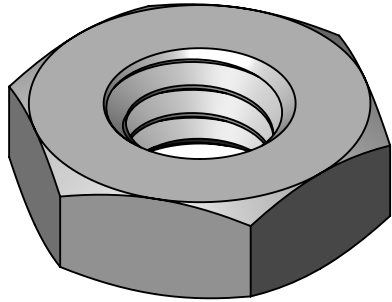

P/N 3843-000  
5/16"-18 Heavy Hex Jam Nut  
Tin Plated 360 Brass Alloy

Part Material :  
Tin Plated Brass Alloy

ALL DIMENSIONS GIVEN AS : INCH [METRIC]  
TOLERANCES UNLESS OTHERWISE SPECIFIED :  
HARDWARE PRODUCTS :  $\pm .010"$  /  $\pm 0.25\text{mm}$

PRINTED COPIES ARE NOT CONTROLLED  
**PROPRIETARY AND CONFIDENTIAL**  
THE INFORMATION CONTAINED IN THIS  
DRAWING IS THE SOLE PROPERTY OF  
VTE INCORPORATED. ANY REPRODUCTION  
IN PART OR AS A WHOLE WITHOUT THE WRITTEN  
PERMISSION OF VTE INCORPORATED PROHIBITED.



**VTE INCORPORATED**

5437 Robinson Road, P.O. Box 790  
Pellston, Michigan 49769 USA  
Telephone : 1-800-527-9256, 231-539-8000  
Fax : 231-539-0914, EFax : 231-344-5914

REV	<b>C</b>	NAME	DATE
DRAWN BY:	RAS	1-12-23	
CHECKED BY:			
SIZE	<b>A</b>	DO NOT SCALE DRAWING	

TITLE:  
5/16"-18 Tin Plated Brass Contact Nut  
DWG. NO. **3843-000**