

REVISIONS			
REV.	DESCRIPTION	DATE	APPROVED
D	Redrawn in Solidworks	12/4/2023	RAS

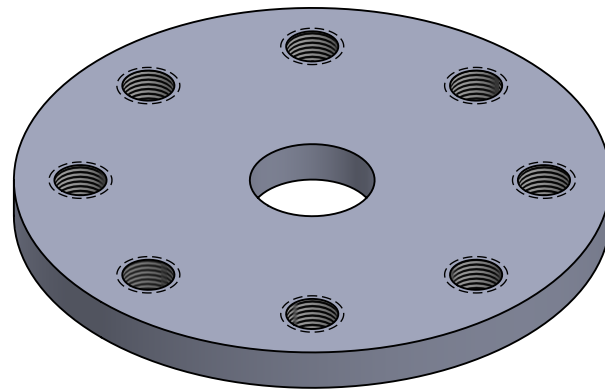
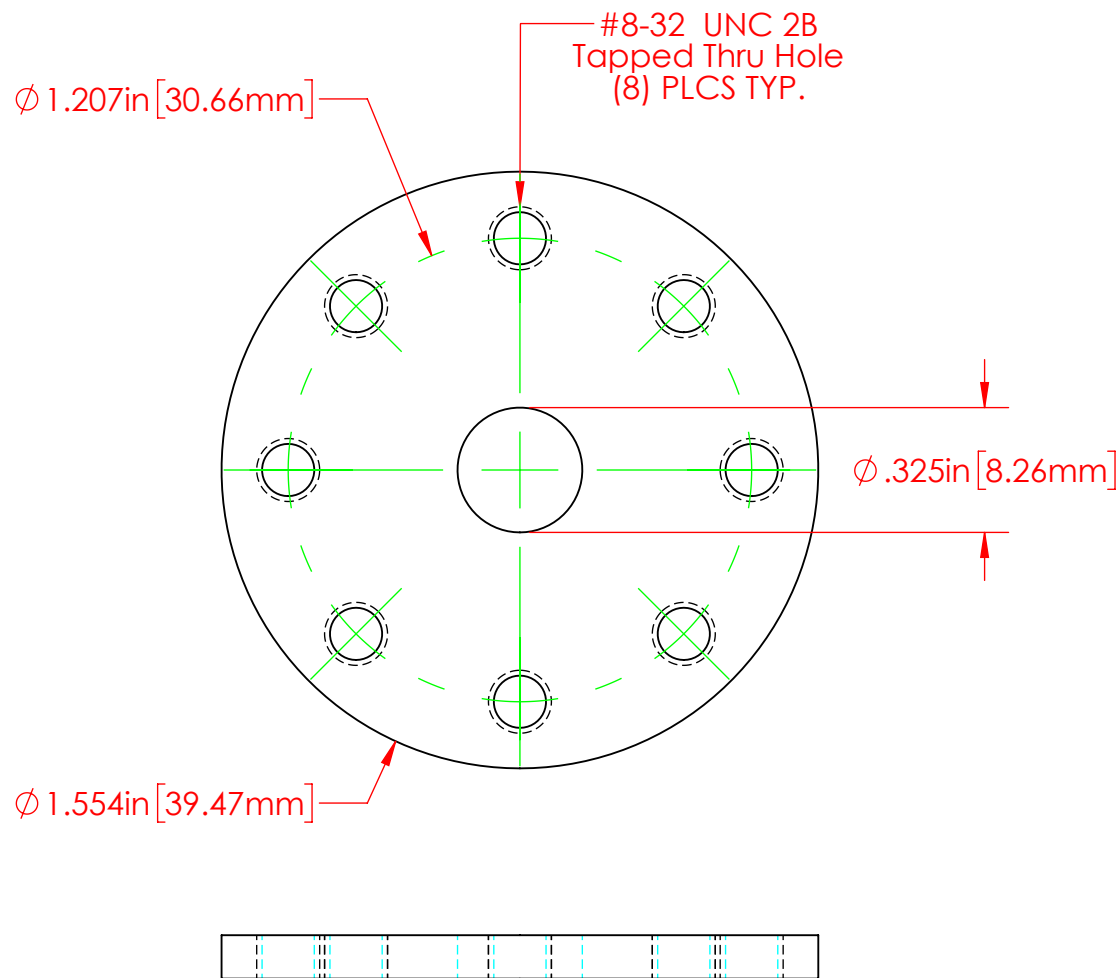

P/N 3875-000  
Nickel Plated 360 Brass Alloy  
8 Point Power Post  
5/16" Contact Distribution Disk

Part Material :  
Nickel Plated Brass Alloy

ALL DIMENSIONS GIVEN AS : INCH [METRIC]  
TOLERANCES UNLESS OTHERWISE SPECIFIED :  
HARDWARE PRODUCTS :  $\pm .010"$  /  $\pm 0.25\text{mm}$

PRINTED COPIES ARE NOT CONTROLLED

**PROPRIETARY AND CONFIDENTIAL**

THE INFORMATION CONTAINED IN THIS  
DRAWING IS THE SOLE PROPERTY OF  
VTE INCORPORATED. ANY REPRODUCTION  
IN PART OR AS A WHOLE WITHOUT THE WRITTEN  
PERMISSION OF VTE INCORPORATED PROHIBITED.



**VTE INCORPORATED**

5437 Robinson Road, P.O. Box 790  
Pellston, Michigan 49769 USA  
Telephone : 1-800-527-9256, 231-539-8000  
Fax : 231-539-0914, Efax : 231-344-5914

REV **D**  
SIZE **A**

NAME	DATE
RAS	12-4-23
CHECKED BY:	
DO NOT SCALE DRAWING	

TITLE: 5/16" Contact Distribution Disk

DWG. NO. **3875-000**