

THE INFORMATION CONTAINED IN THIS DRAWING IS THE SOLE PROPERTY OF VTE INCORPORATED. ANY REPRODUCTION IN PART OR WHOLE WITHOUT THE WRITTEN PERMISSION OF VTE INCORPORATED IS PROHIBITED.

LTR.	REVISIONS	DATE	INT.
△	ADDED SPACER 330N3N02	19DEC13	RAS
Ⓑ	ADDED FASTENER TORQUE SPEC	2SEP16	RAS

VTE MAKES NO WARRANTY, EXPRESSED OR IMPLIED, AS TO THE SUITABILITY OF A PRODUCT FOR ANY INTENDED USE. THE CUSTOMER SHALL BEAR THE SOLE RESPONSIBILITY OF DETERMINING THE SUITABILITY OF ANY VTE PRODUCT FOR ITS END USE.

USE GREENLEE  
PUNCH ASSEMBLY  
#60098 FOR PANEL  
CUTOUT

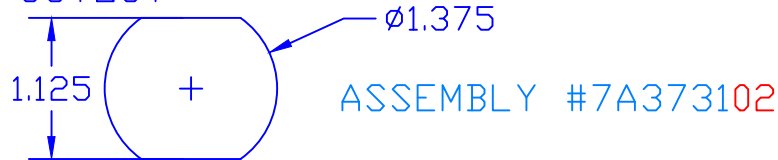

P/N 3531N02  
3/8" INNER PANEL BUSHING  
FOR 1/4" PANEL THICKNESS

#3838-000 3/8"-16  
BRASS JAM NUT  
BLUE DOT TECHNOLOGY  
P/N 3740-002  
3/8"-16 UNC X 1.5"  
STAINLESS STEEL BOLT

#3638-000 STAINLESS  
STEEL SPLIT LOCK WASHER

DO NOT SCALE

#3438N02 3/8" OUTER PANEL  
BUSHING (WEATHERPROOF)

#3646-000 STAINLESS  
STEEL FLATWASHER

321N9V02  
TERMINAL COVER

3860-001 BRASS HEX CAP NUT  
P/N 330N3N02 SPACER  
(AS REQ'D.) BY INSTRUCTION  
SHEET #16805110901

TOLERANCE UNLESS OTHERWISE SPECIFIED:  
MOLDED ITEMS: ±.030"/±0.8mm  
HARDWARE ITEMS: ±.010"/±0.25mm  
RADIAL DIAMETERS TO BE MEASURED OVER MANDRELS,  
RING GAGES OR PIN GAGES OF SUITABLE SIZE

Ⓑ MAXIMUM RECOMMENDED FASTENER TORQUE:  
S.S. JAM NUT- 180 IN./LBS.  
BRASS JAM NUT- 72 IN./LBS.

INCLUDES P-16808110001 BLUE DOT MULTI LABEL, 1 PER CONTAINER  
MAXIMUM AMPERAGE: 50 AMPS@ 12VDC

BASE MATERIAL: GLASS-REINFORCED NYLON  
BASE MATERIAL U.L. RATING: 94 HB

VTE Incorporated  
5437 Robinson Road, P.O. Box 790  
Pellston, Michigan 49769  
Telephone: 1-800-527-9256, 231-539-8000  
FAX: 231-539-0914

REF: 7A SERIES	DATE: 06AUG03	DRN BY: BRH CHK'D BY: BRH	WEIGHT:
TITLE: POWER CONNECTOR, AUX. 3/8" STUD 1/4" MAX PANEL			SCALE: NONE
MATERIAL:		PART NO. 7A373102	
COLOR: RED	DRG CLASS REV B		