

THE INFORMATION CONTAINED IN THIS DRAWING IS THE SOLE PROPERTY OF VTE INCORPORATED. ANY REPRODUCTION IN PART OR WHOLE WITHOUT THE WRITTEN PERMISSION OF VTE INCORPORATED IS PROHIBITED.

LTR.	REVISIONS	DATE
≠	*****	00-000-00

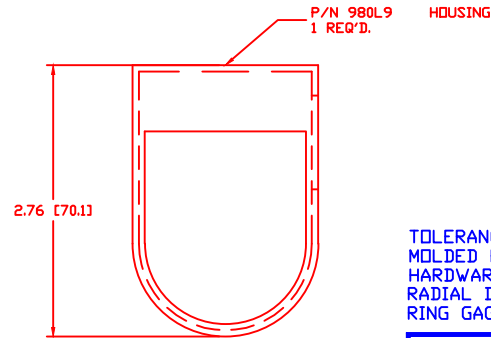
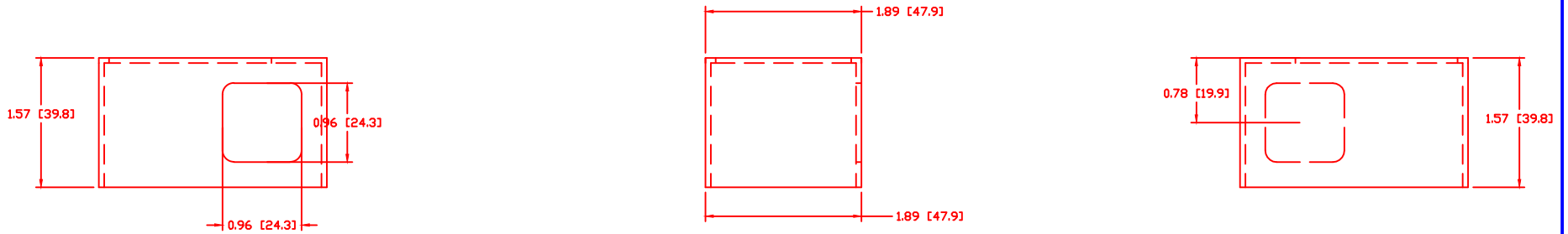

TOLERANCE UNLESS OTHERWISE SPECIFIED:
 MOLDED PRODUCTS ONLY: $\pm 0.30^\circ / \pm 0.8\text{mm}$
 HARDWARE ITEMS: $\pm 0.010^\circ / \pm 0.25\text{mm}$
 RADIAL DIAMETERS TO BE MEASURED OVER MANDRELS,
 RING GAGES OR PIN GAGES OF SUITABLE SIZE

Material:
 VTE Material Part No:
 Max. Operating Temp:
 Durometer:
 Specific Gravity:
 Ult. Elongation %:
 Modulus PSI:
 Tensile Strength PSI:
 Dielectric Strength, v./ml
 MEETS:

Polypropylene
 7209750302
 550 F
 110 R-Scale
 1.13
 2.5
 Not Tested
 9500
 Not Tested
 UL94HB



VTE Incorporated
 5437 Robinson Road, P.O. Box 790
 Pellston, Michigan 49769
 Telephone: 1-800-527-9256, 231-539-8000
 FAX: 231-539-0914

REF: *****	DATE: 26JUL07	DRN BY: BRH	WEIGHT: *****
TITLE: COVER ASM., "L" POST LARGE			SCALE:
MATERIAL:		PART NO.	
COLOR: *****	DRG CLASS *****	980L9 P02	